

FLAT PACK OFFICE CABIN

SIDE LINKING KIT INSTALLATION INSTRUCTIONS

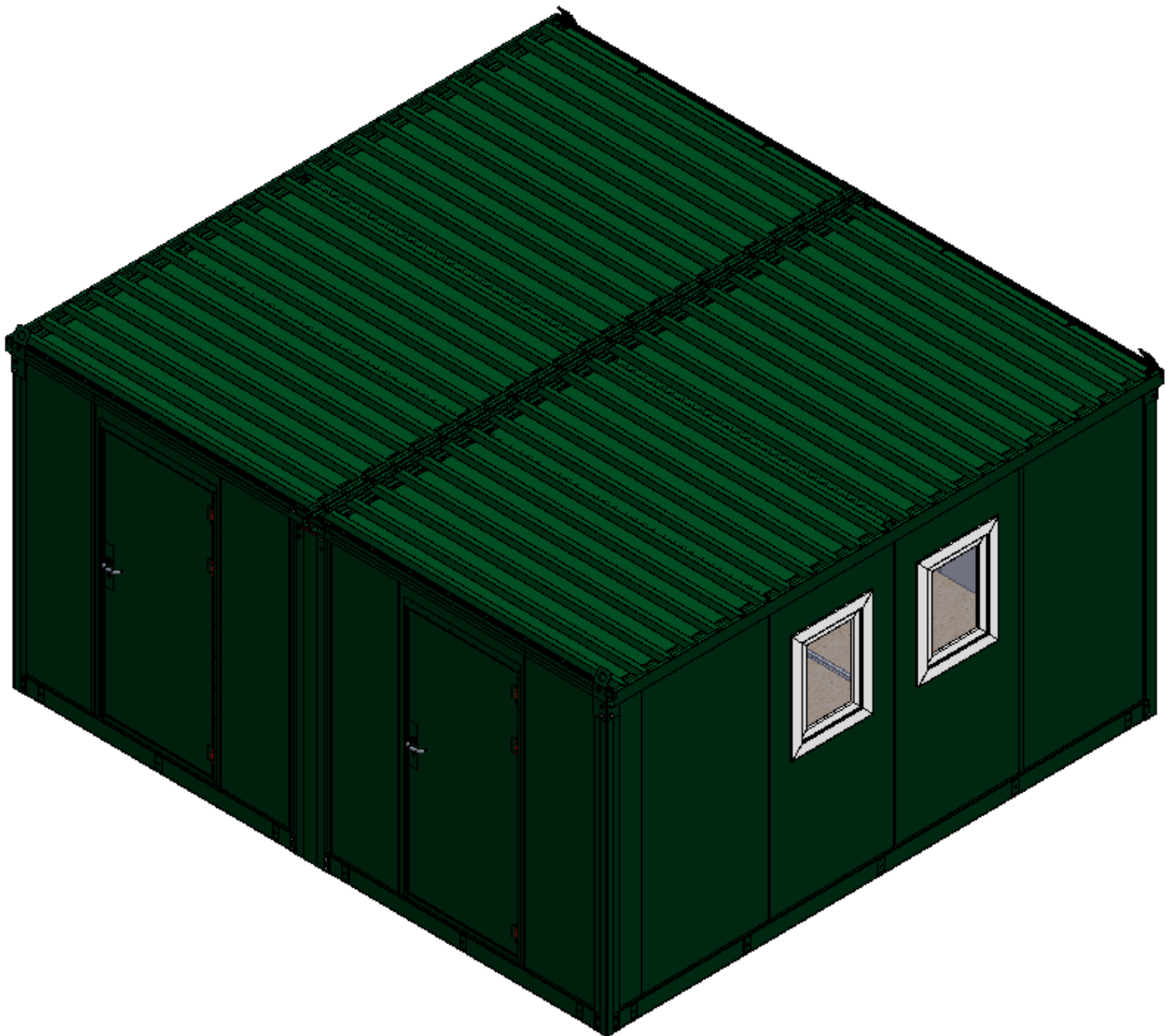

Parts and quantities to be used for connection.

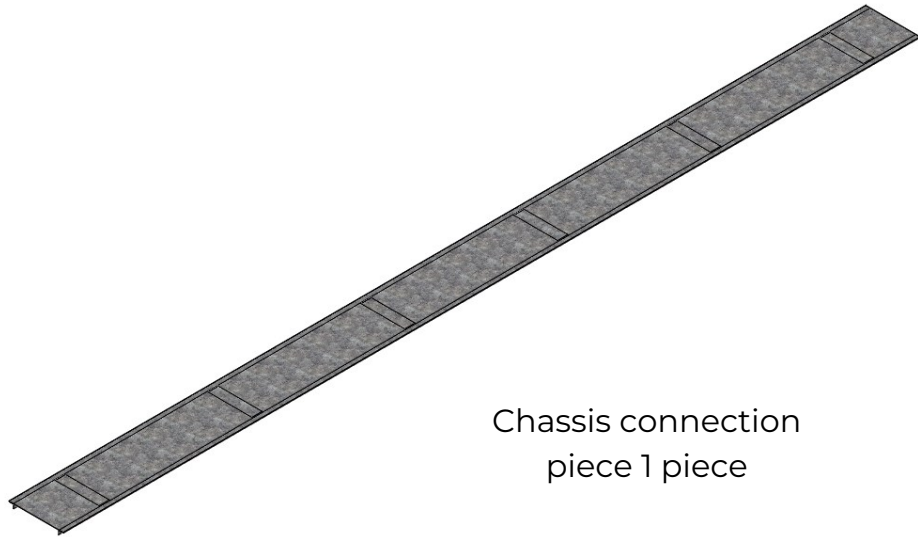

Chassis connection
piece 1 piece

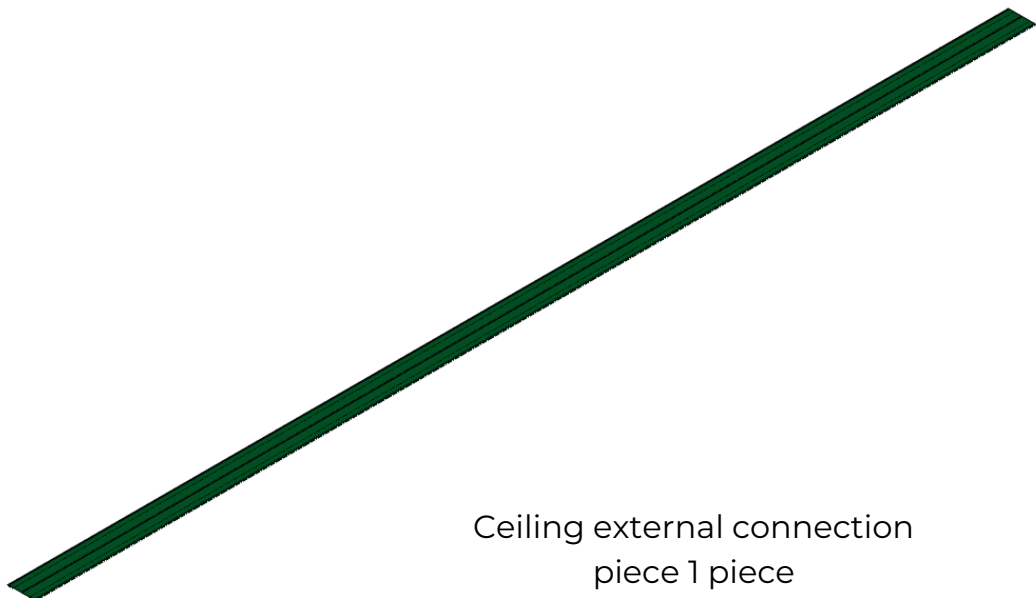

Ceiling external connection
piece 1 piece

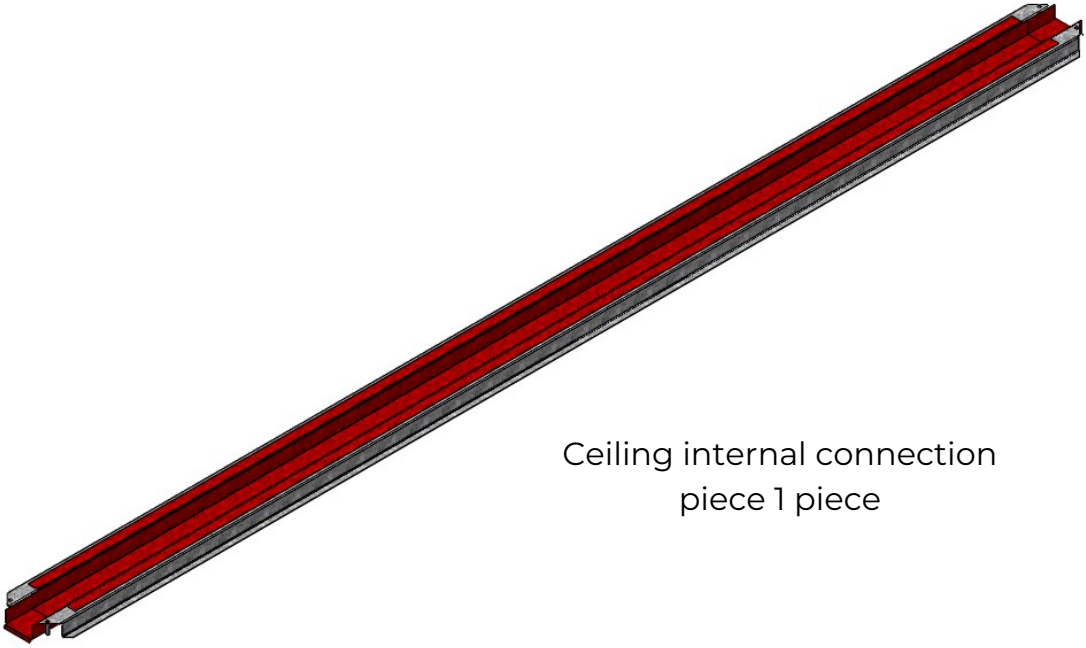

Ceiling internal connection
piece 1 piece



Side outer joint piece
2 piece



Side inner joint piece
2 piece



Ceiling closure
piece 2 piece

1. To begin assembly, first place the chassis on a flat

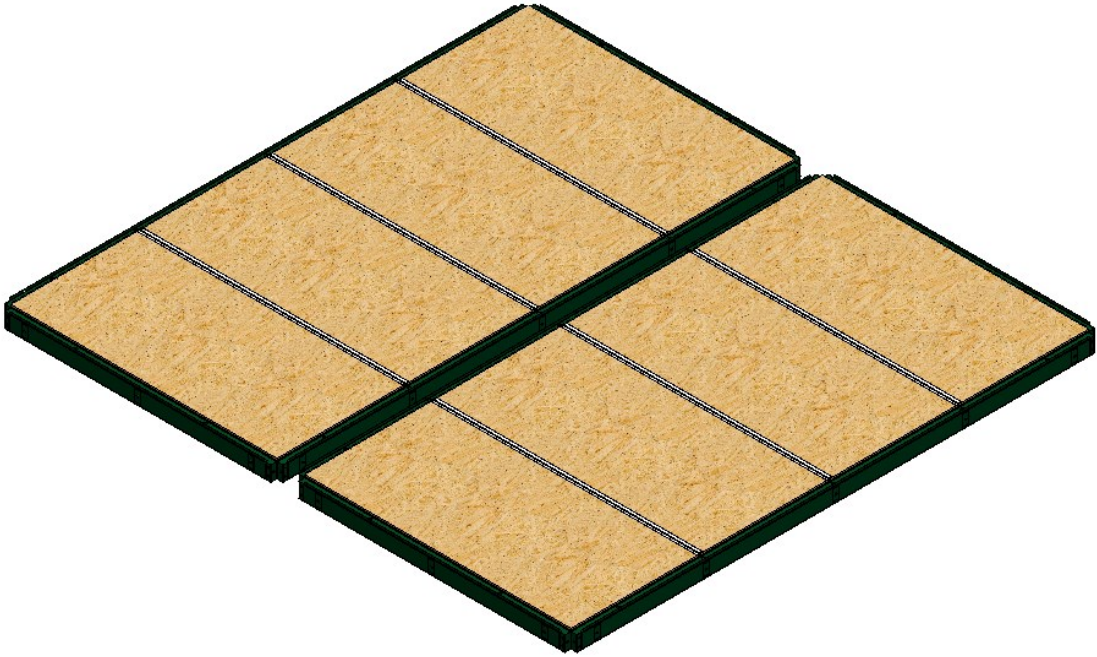

2. Place the chassis connection piece between the two chassis.

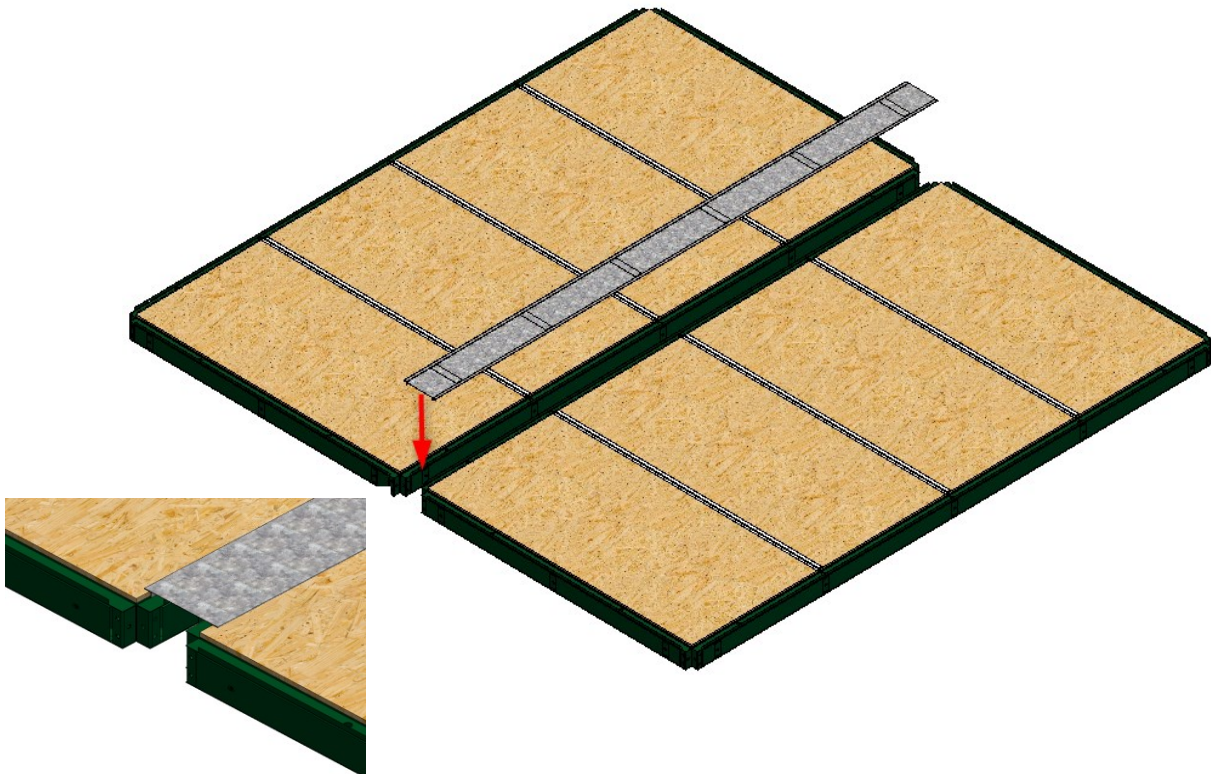

3. After the chassis placement is done, assemble one of the cabins and only the rear panels of the second cabin.

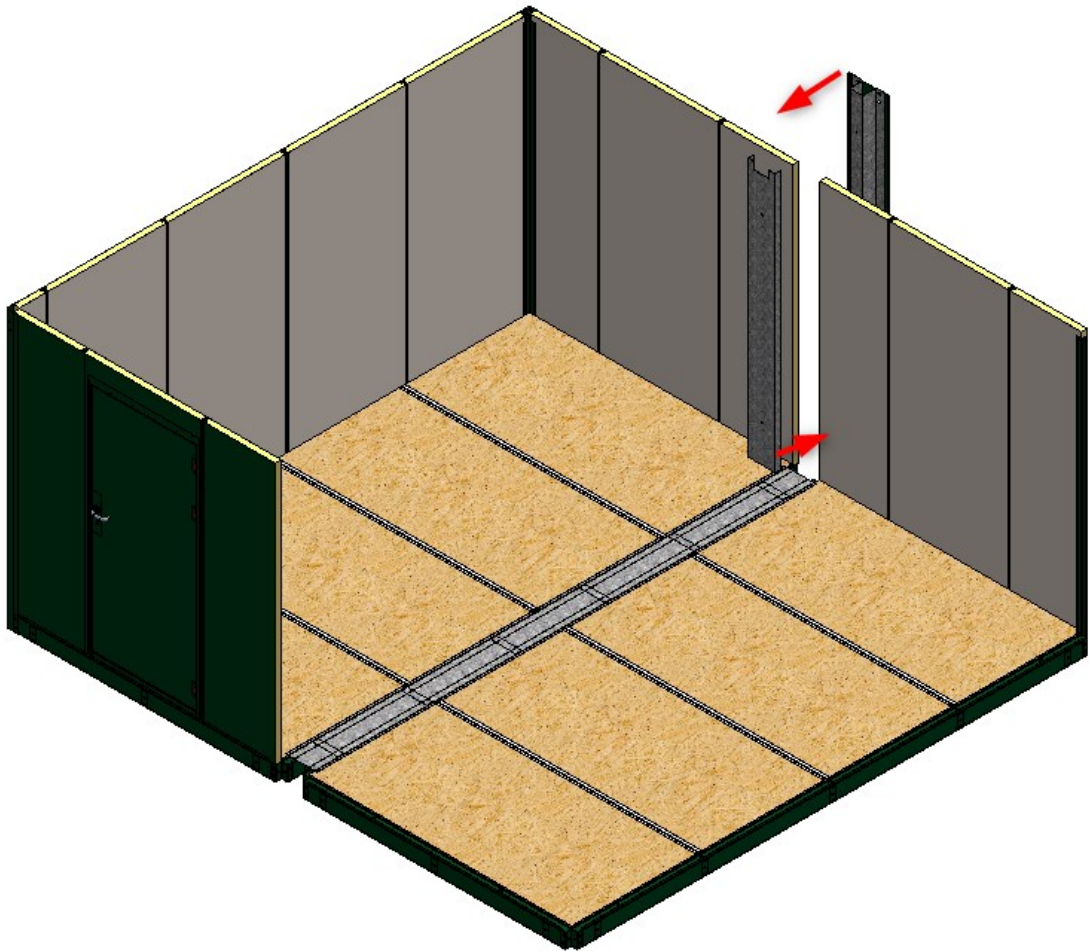

4. For the connection of the side outer part, 8 M12x25 bolts and 8 M12 washers are used.

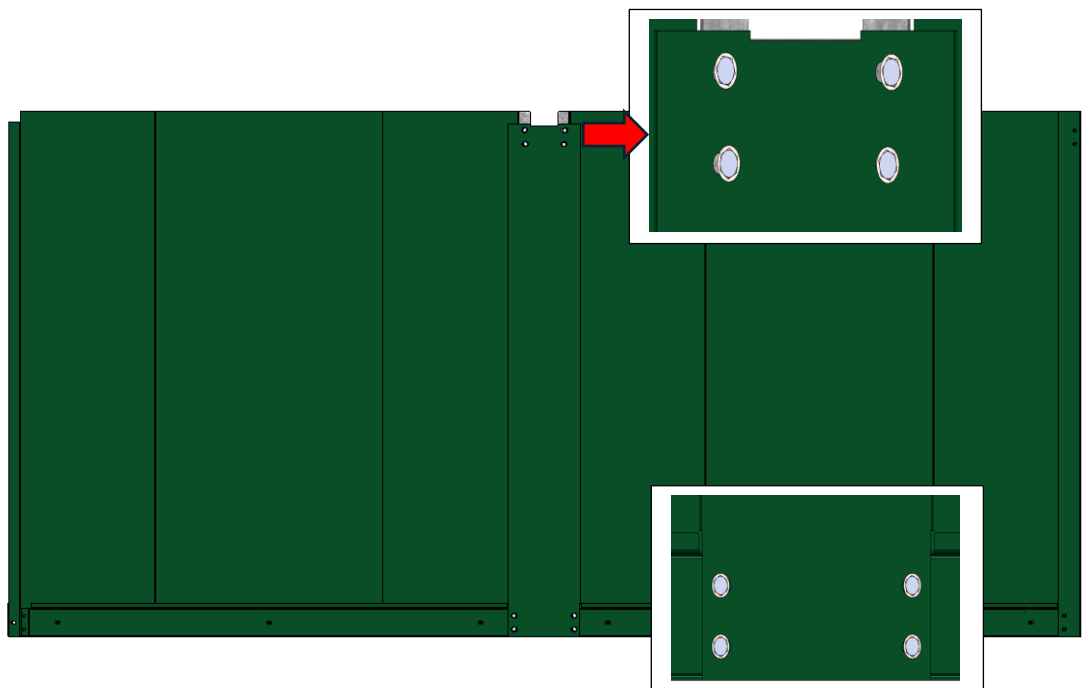

5. The side inner connection part is mounted with 2 M8 bolts and 2 M8 washers.

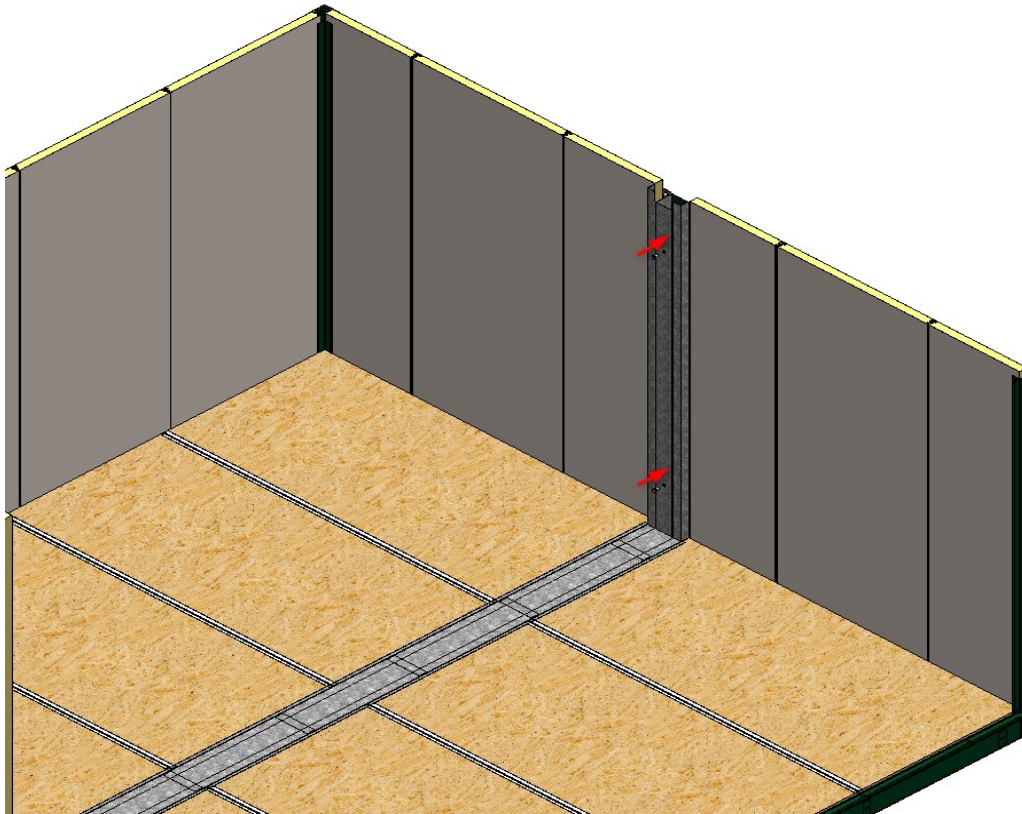

6. The other panels of the cabin are installed and then the linking kit parts of the other side are installed.

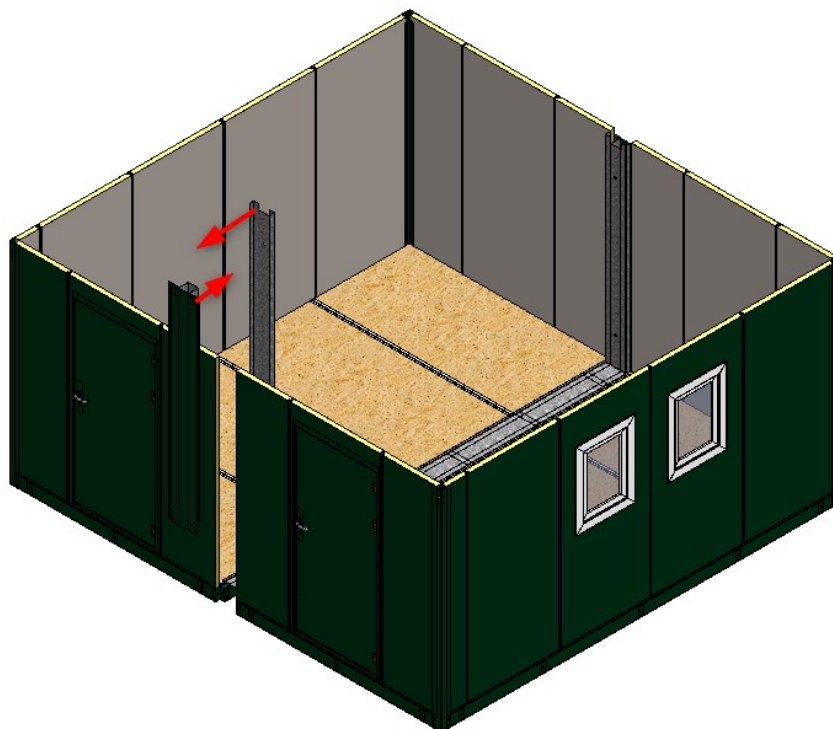

7. The side outer part is fixed with 8 pcs M12x25 bolts and 8 pcs M8 washers and the side inner part is fixed with 2 pcs M8x25 bolts and 2 pcs M8 washers.

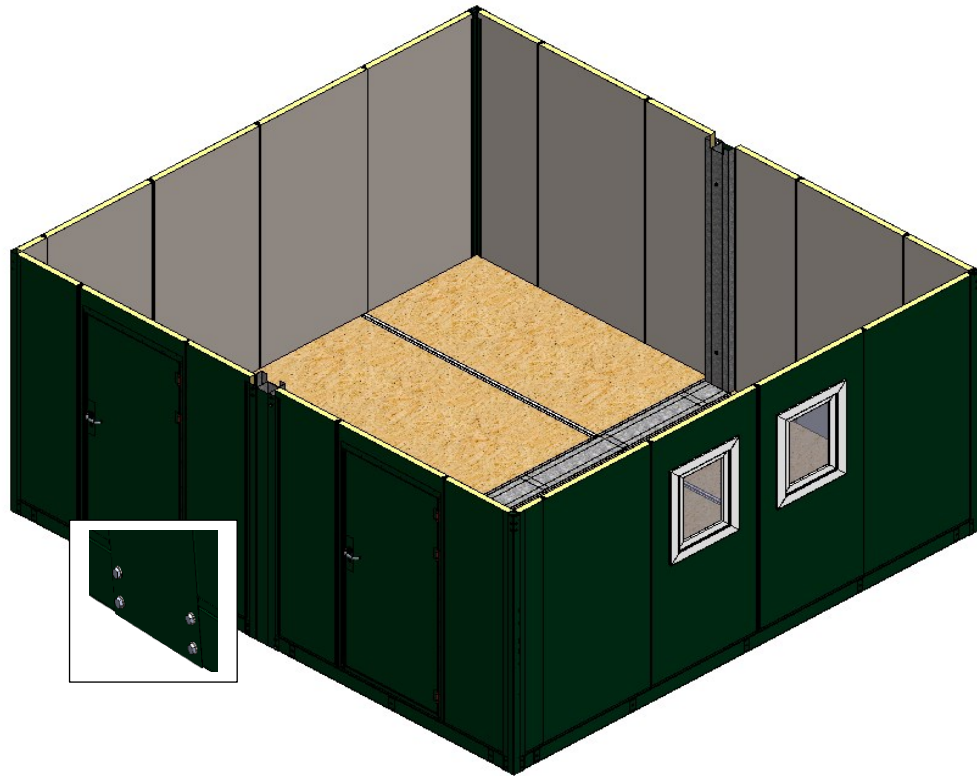

8. The ceiling interior connection piece is placed.

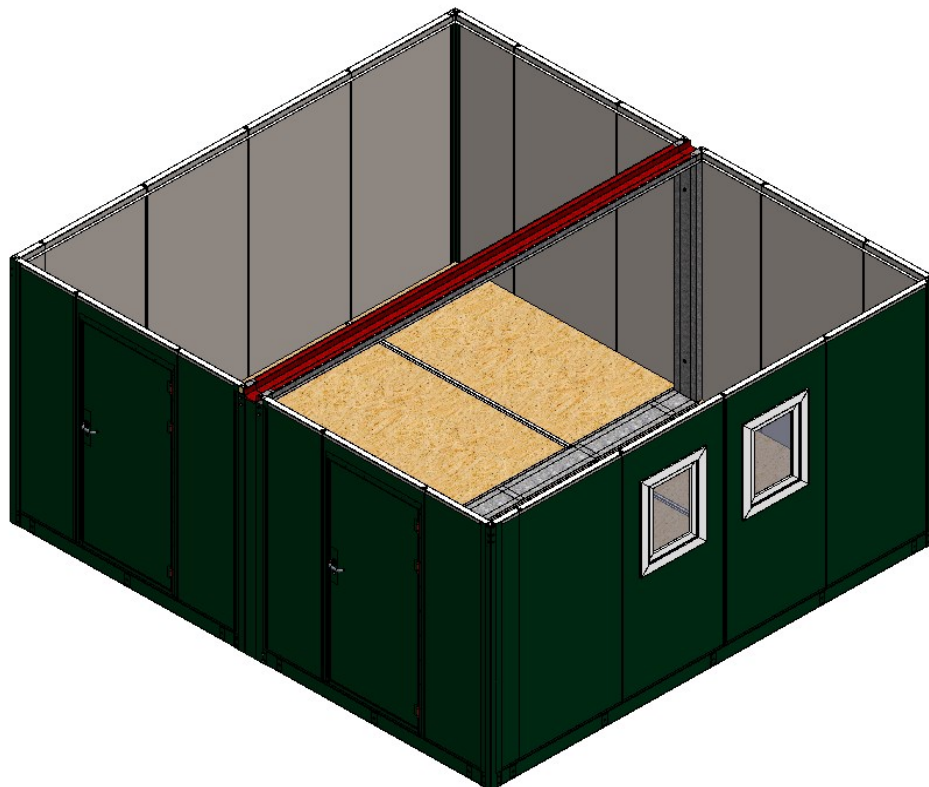

9. After the container's ceiling installation is done, the ceiling outer piece is placed.

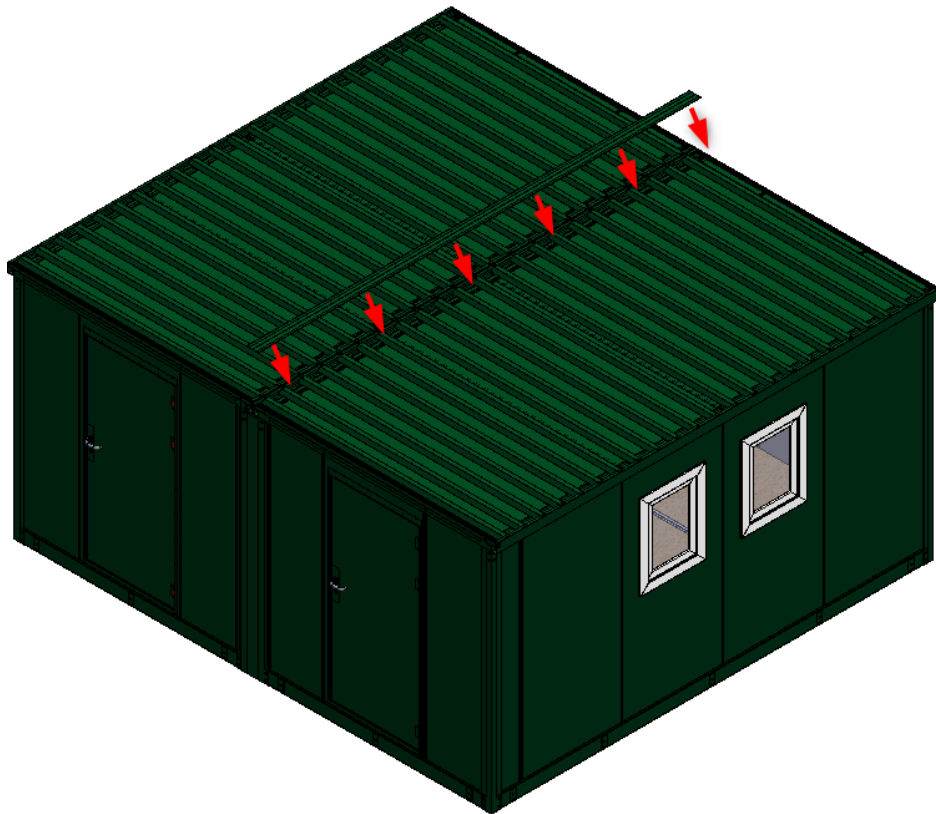

10. 2 pieces of ceiling cover are placed and assembled using M8x25 bolts, M8 washers and M8 nuts through the holes.

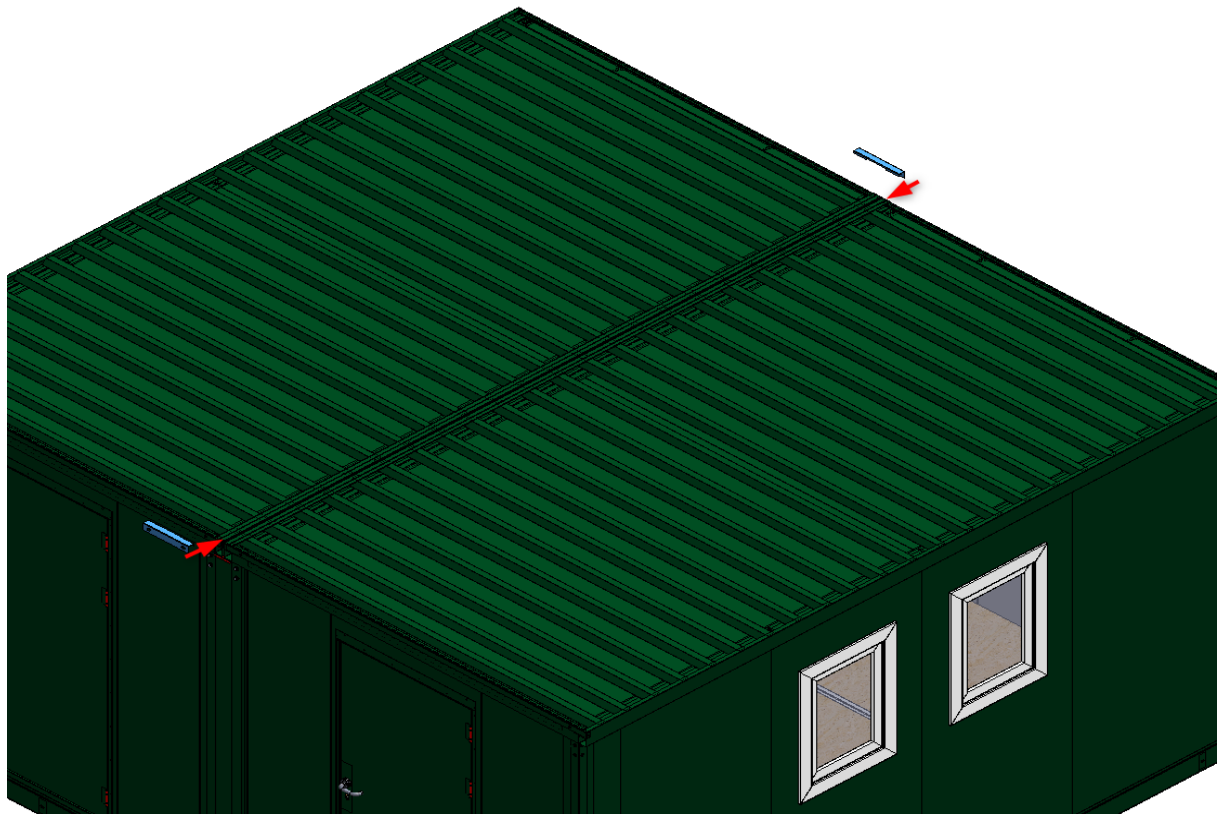

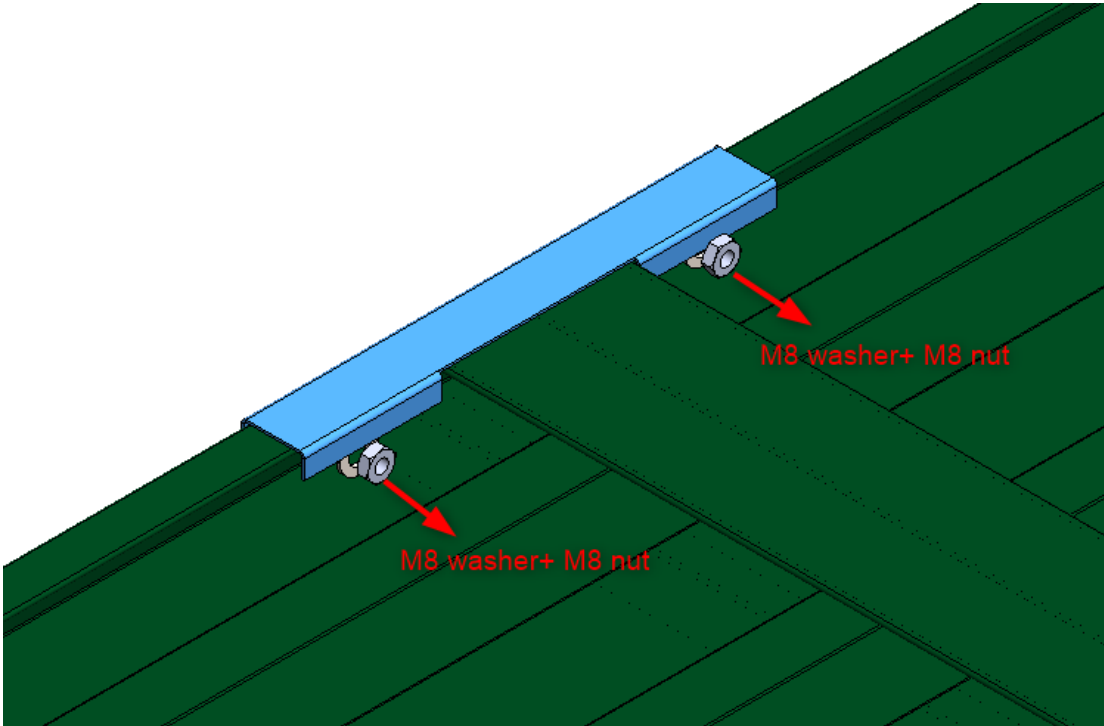
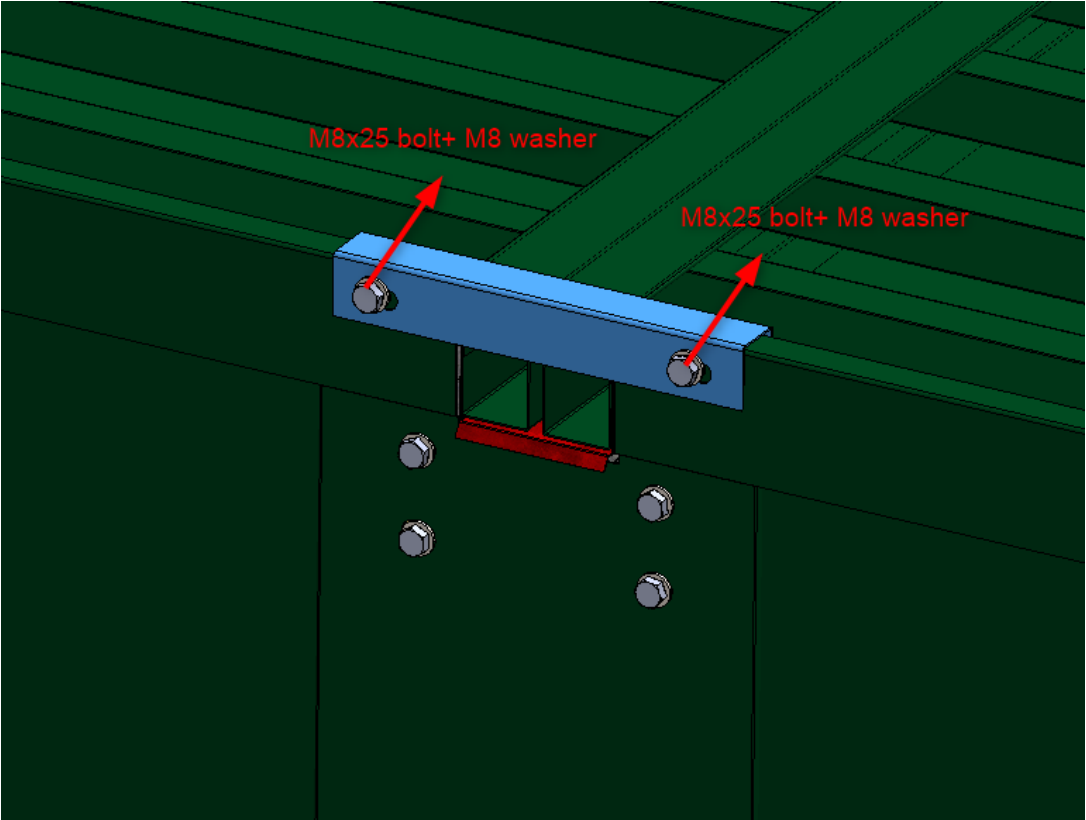

11. Finally, the lifting lugs are assembled and the cabin side linking kit installation is completed.

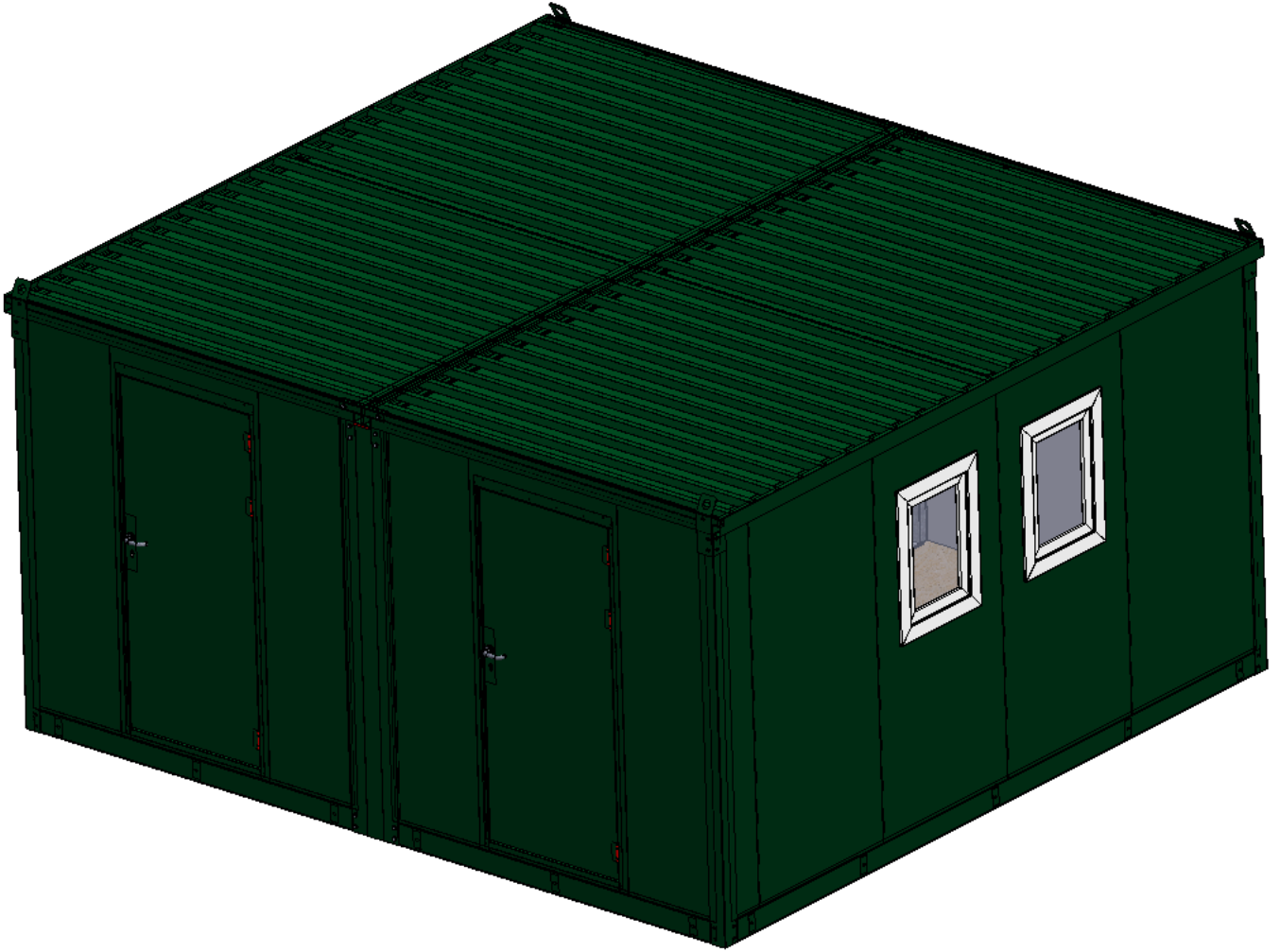

portablespace[®]

cabin & container hire | sales | conversions | modular

Portable Space Ltd,
Modular House, Bacton Business Park,
Stowmarket, Suffolk, IP14 4LE

T: +44(0) 01449 782123
info@portablespace.co.uk
www.portablespace.co.uk